

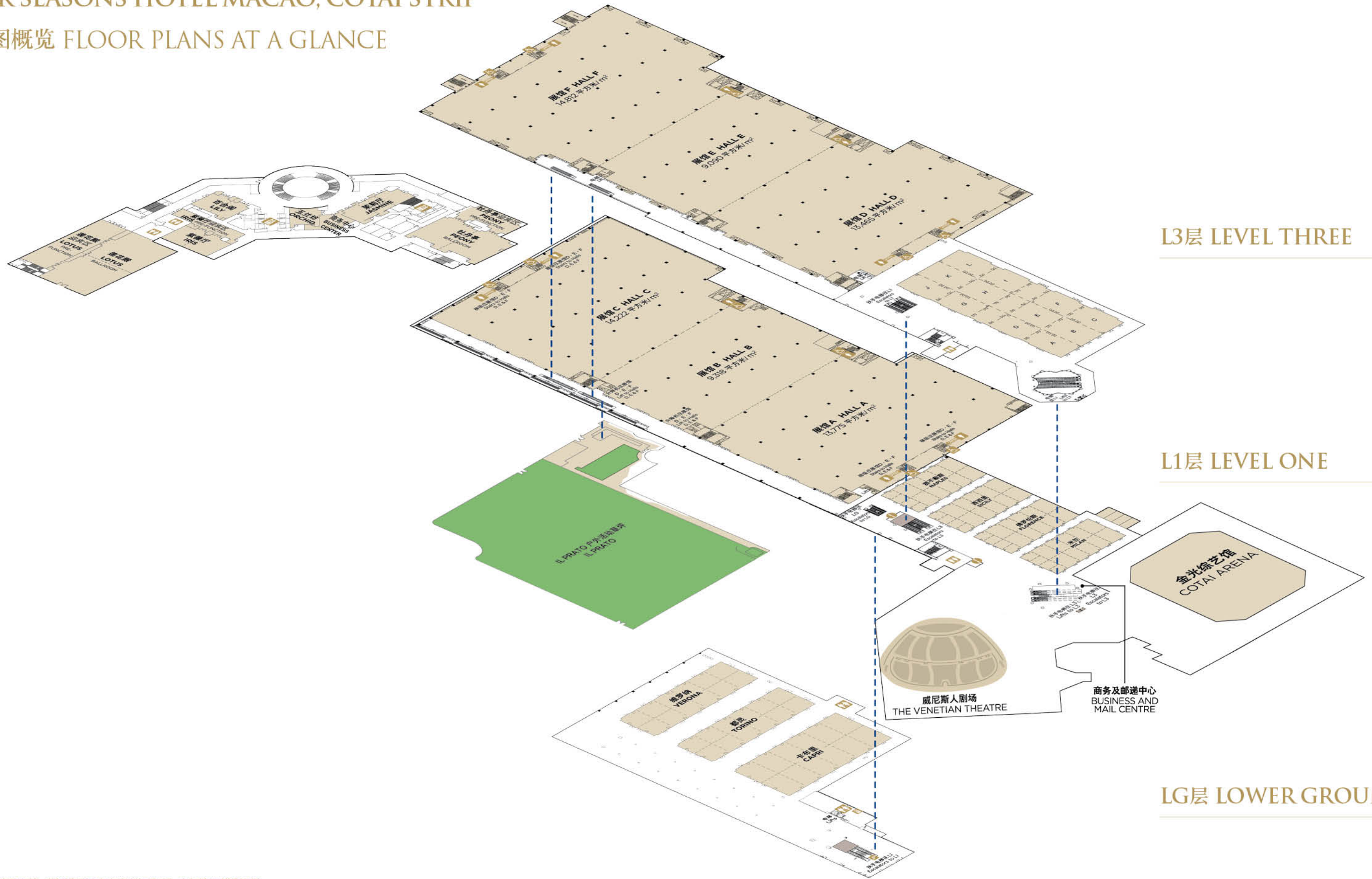

# 澳门威尼斯人及澳门四季酒店

## THE VENETIAN MACAO AND FOUR SEASONS HOTEL MACAO, COTAI STRIP

### 平面图概览 FLOOR PLANS AT A GLANCE



L3层 LEVEL THREE

L1层 LEVEL ONE

LG层 LOWER GROUND



# 金光综艺馆—澳门威尼斯人

## COTAI ARENA - THE VENETIAN MACAO

### L1层 LEVEL ONE

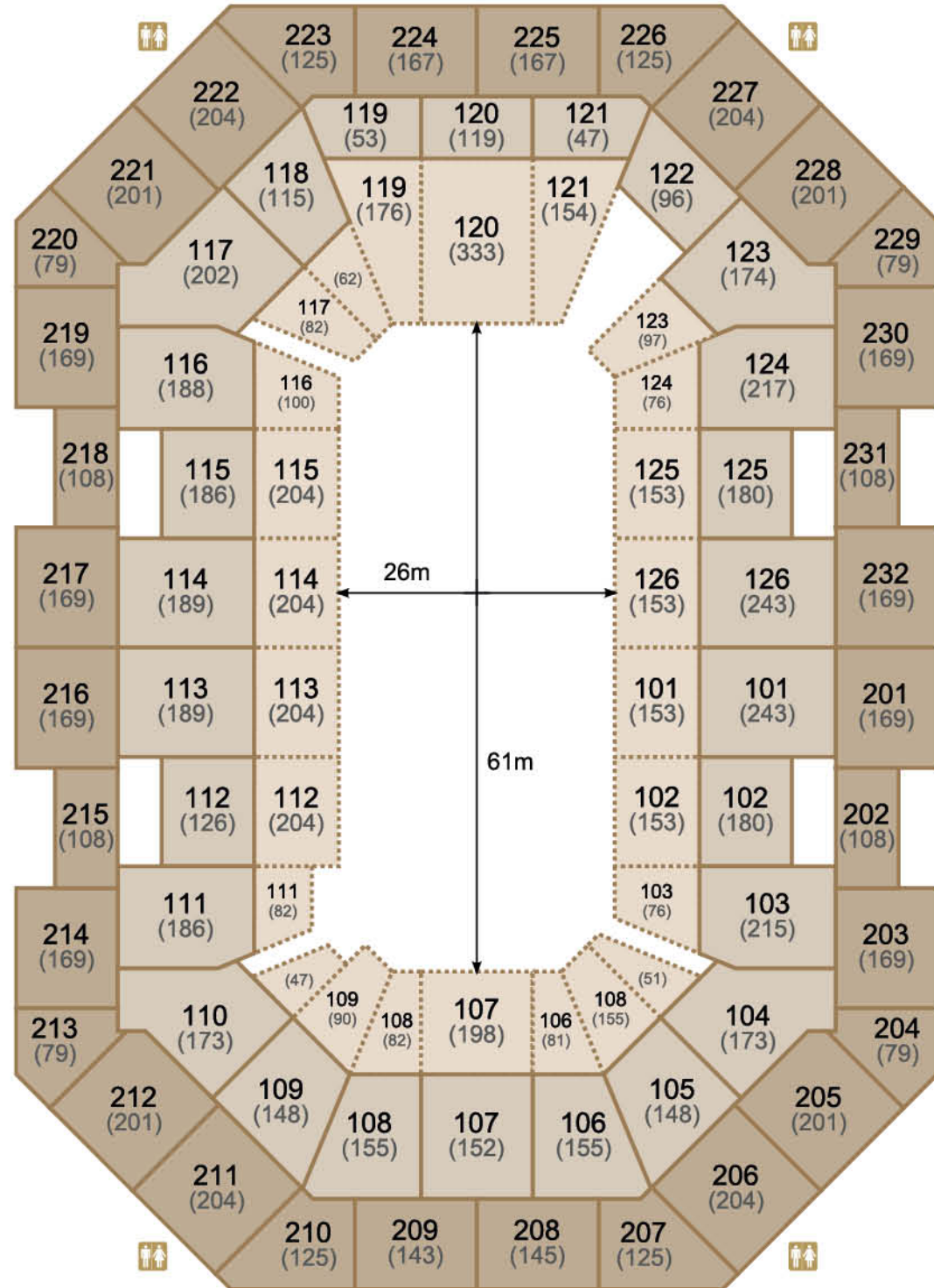

洗手间 RESTROOM

金光综艺馆 Cotai Arena	可容纳人数 Capacity
观众席 Auditorium	15,000
四面台 Conference 360	13,316
三面台 End Stage	12,525
两面台 Side Stage	8,163

景观将视乎不同房间配置而定。所有的资讯在打印时已经确认正确无误。本公司有权对其进行更改。  
Room configuration may have obstructed views. All information is correct at the time of printing but may be subject to change without notice.

# 威尼斯人剧场

## THE VENETIAN THEATRE

### L1层 LEVEL ONE

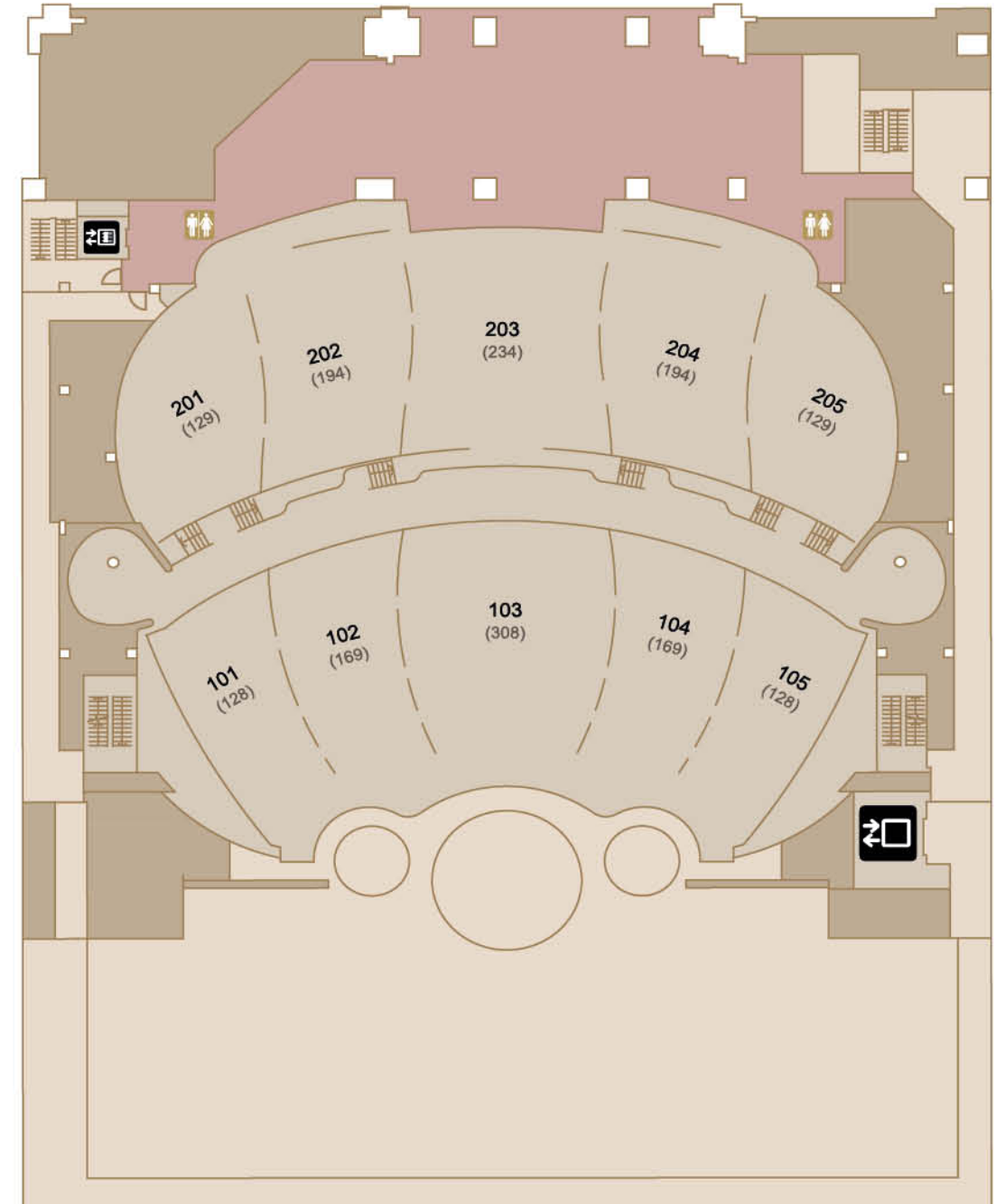

洗手间 RESTROOM

威尼斯人剧场 The Venetian Theatre	可容纳人数 Capacity
上层 Upper level	881
下层 Lower level	899
总容纳人数 Total	1,780

# 金光会展 - 澳门威尼斯人

## COTAI EXPO - THE VENETIAN MACAO

### L1层 LEVEL ONE

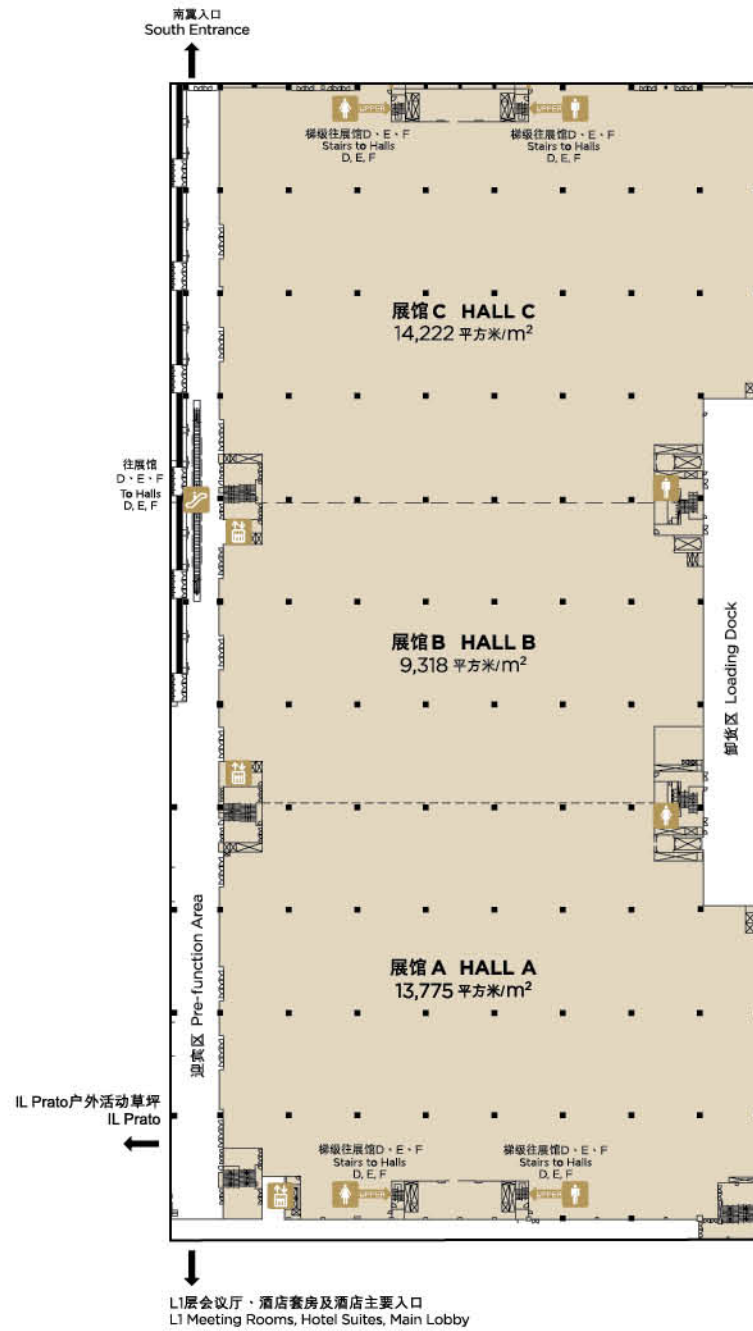

- 扶手电梯 ESCALATOR
- 升降机 LIFT
- 洗手间 RESTROOM

金光会展 - L1层 Cotai Expo - Level One		展位数量 Booth Capacity	平方米 Area (sqm)
总面积 Total Area	展馆 Halls A, B, C	2,060	37,315
L1层 Level One	展馆 Hall A	720	13,775
	展馆 Hall B	557	9,318
	展馆 Hall C	783	14,222
	迎展区 Pre-function Area	-	2,752

景观将视乎不同房间配置而定。所有的资讯在打印时已经确认正确无误，本公司有权对其进行更改。  
Room configuration may have obstructed views. All information is correct at the time of printing but may be subject to change without notice.

# 金光会展 - 澳门威尼斯人

## COTAI EXPO - THE VENETIAN MACAO

### L3层 LEVEL THREE

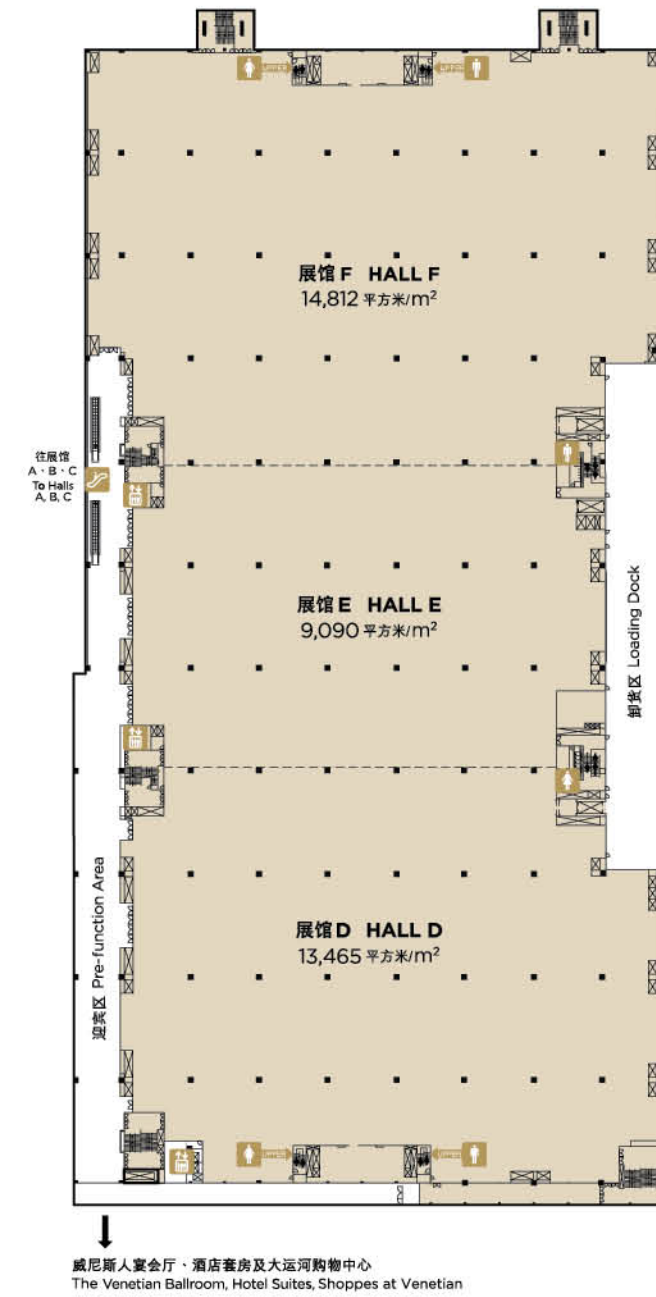

- 扶手电梯 ESCALATOR
- 升降机 LIFT
- 洗手间 RESTROOM

金光会展 - L3层 Cotai Expo - Level Three		展位数量 Booth Capacity	平方米 Area (sqm)
总面积 Total Area	展馆 Halls D, E, F	1,965	37,367
L3层 Level Three	展馆 Hall D	672	13,465
	展馆 Hall E	524	9,090
	展馆 Hall F	769	14,812
	迎展区 Pre-function Area	-	2,212



# 威尼斯人宴会厅

## THE VENETIAN BALLROOM

### L3层 LEVEL THREE

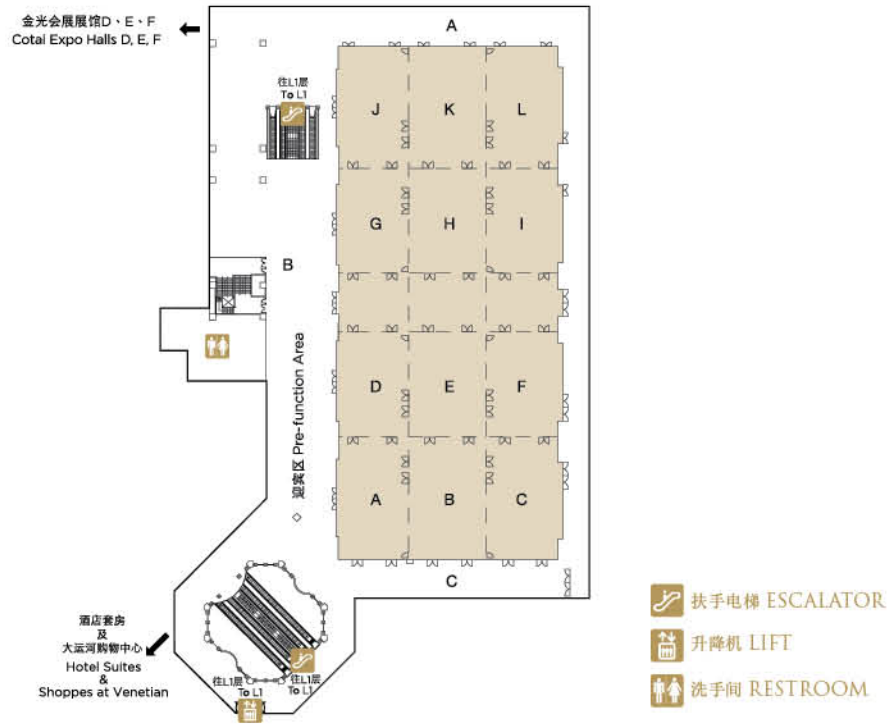

# 会议厅 - 澳门威尼斯人

## MEETING ROOMS - THE VENETIAN MACAO

### L1层 LEVEL ONE

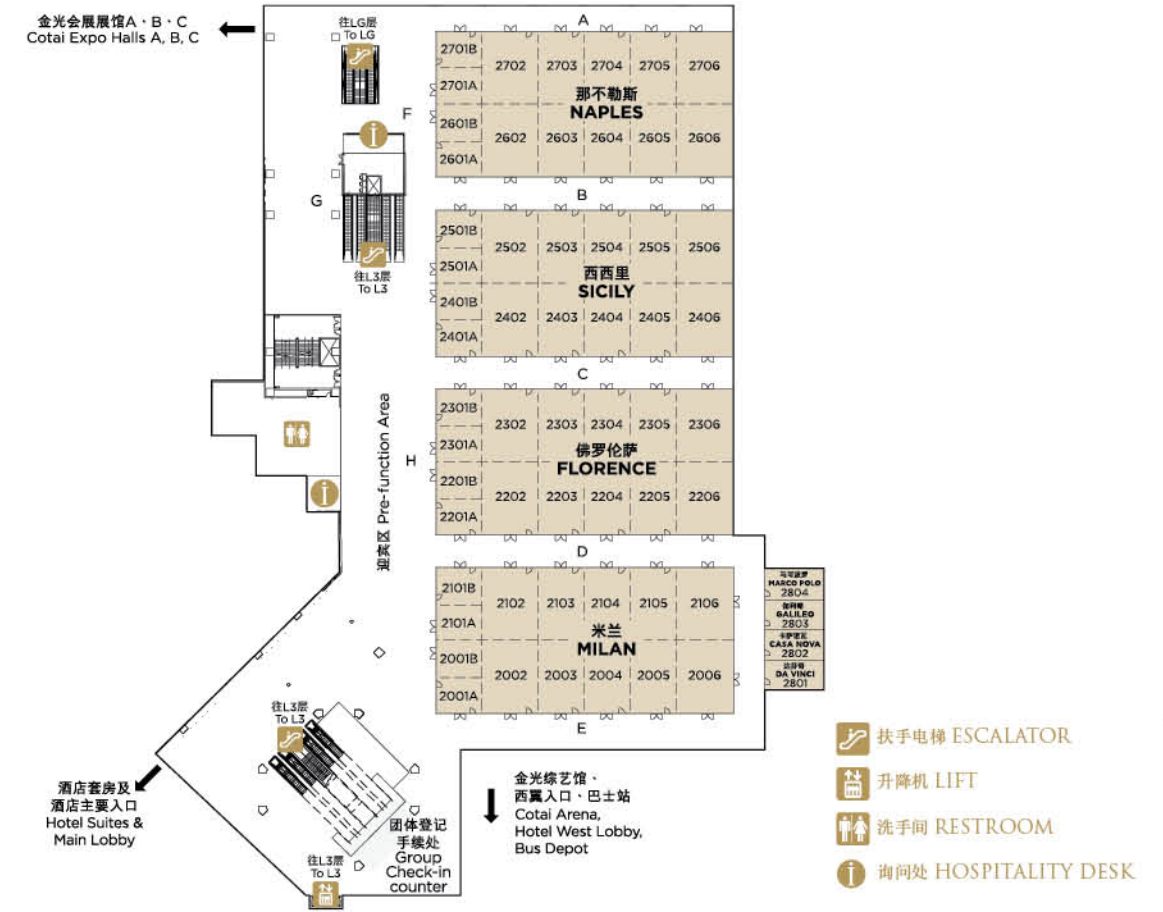

威尼斯人宴会厅 The Venetian Ballroom	平方米 Area (sqm)	尺寸 (米) Dimensions (M)	楼高 (米) Height (M)	可容纳人数 Capacities						
				剧院模式 Theatre	课室模式 Classroom	宴会模式 Banquet	招待会模式 Reception	会议模式 Conference	U型模式 U-Shape	空心矩形模式 Hollow Square
宴会厅 Ballroom	6,577	121.80 x 54.00	7.50	7,450	3,500	5,060	7,300	-	-	-
A	470	28.35 x 16.60	7.50	470	255	360	522	-	88	92
B	581	28.35 x 20.50	7.50	580	315	440	645	-	109	114
C	473	28.35 x 16.70	7.50	470	255	360	525	-	89	93
D	459	27.70 x 16.60	7.50	460	248	350	510	-	86	90
E	567	27.70 x 20.50	7.50	565	305	430	630	-	106	111
F	462	27.70 x 16.70	7.50	460	250	350	513	-	87	110
走廊 Corridor	502	54.00 x 9.30	7.50	-	-	-	-	-	-	-
G	459	27.70 x 16.60	7.50	460	248	350	510	-	86	90
H	567	27.70 x 20.50	7.50	565	305	430	630	-	106	111
I	462	27.70 x 16.70	7.50	460	250	350	513	-	87	110
J	470	28.35 x 16.60	7.50	470	255	360	522	-	88	92
K	581	28.35 x 20.50	7.50	580	315	440	645	-	109	114
L	473	28.35 x 16.70	7.50	470	255	360	525	-	89	93
宴会厅 Ballroom A&B	1,051	28.35 x 37.10	7.50	1,165	568	810	1,167	-	-	-
宴会厅 Ballroom A-C	1,530	28.35 x 54.00	7.50	1,700	827	1,170	1,700	-	-	-
宴会厅 Ballroom A&D	932	56.20 x 16.60	7.50	1,035	503	710	1,035	-	-	-
宴会厅 Ballroom A-F	3,034	56.20 x 54.00	7.50	3,370	1,640	2,330	3,371	-	-	-
宴会厅 Ballroom A-I	5,040	93.35 x 54.00	7.50	5,600	2,724	3,870	5,600	-	-	-
宴会厅 Ballroom D&E	1,027	27.70 x 37.10	7.50	1,140	555	790	1,141	-	-	-
宴会厅 Ballroom D-F	1,495	27.70 x 54.00	7.50	1,660	808	1,150	1,661	-	-	-
宴会厅 Ballroom D-I	3,493	64.70 x 54.00	7.50	3,880	1,888	2,680	3,881	-	-	-
宴会厅 Ballroom D-L	5,040	93.35 x 54.00	7.50	5,600	2,724	3,870	5,600	-	-	-
宴会厅 Ballroom G&H	1,027	27.70 x 37.10	7.50	1,140	555	790	1,141	-	-	-
宴会厅 Ballroom G-I	1,495	27.70 x 54.00	7.50	1,660	808	1,150	1,661	-	-	-
宴会厅 Ballroom G&J	932	56.20 x 16.60	7.50	1,035	503	710	1,035	-	-	-
宴会厅 Ballroom G-L	3,034	56.20 x 54.00	7.50	3,370	1,640	2,330	3,371	-	-	-
宴会厅 Ballroom J&K	1,051	28.35 x 37.10	7.50	1,165	568	810	1,167	-	-	-
宴会厅 Ballroom J-L	1,530	28.35 x 54.00	7.50	1,700	827	1,170	1,700	-	-	-
宴会厅 Ballroom ABDE / GHJK	2,085	56.20 x 37.10	7.50	2,315	1,127	1,600	2,316	-	-	-
宴会厅 Ballroom BCEF / HIKL	2,090	56.20 x 37.20	7.50	2,320	1,129	1,600	2,322	-	-	-
迎宾区 Pre-function Area										
A	301	-	-	-	-	-	-	-	-	-
B	1,975	-	-	-	-	-	-	-	-	-
C	301	-	-	-	-	-	-	-	-	-

会议厅 Meeting Rooms	平方米 Area (sqm)	尺寸 (米) Dimensions (M)	楼高 (米) Height (M)	可容纳人数 Capacities						
				剧院模式 Theatre	课室模式 Classroom	宴会模式 Banquet	招待会模式 Reception	会议模式 Conference	U型模式 U-Shape	空心矩形模式 Hollow Square
米兰 MILAN / 佛罗伦萨 FLORENCE										
西西里 SICILY / 那不勒斯 NAPLES										
12间会议厅 12 Rooms	1,306	54.00 x 24.20	5.30	1,400	720	1,040	1,500	-	-	-
10间会议厅 10 Rooms	1,081	44.70 x 24.20	5.30	1,150	558	890	1,200	-	-	-
8间会议厅 8 Rooms	863	35.70 x 24.20	5.30	885	450	700	870	-	-	-
6间会议厅 6 Rooms	647	26.75 x 24.20	5.30	690	350	520	680	-	-	-
4间会议厅 4 Rooms	430	17.80 x 24.20	5.30	440	210	350	460	-	-	-
3间会议厅 3 Rooms	321	26.75 x 12.00	5.30	320	170	260	340	70	60	80
2间会议厅 2 Rooms	213	17.80 x 12.00	5.30	225	100	170	230	60	55	65
1间会议厅 1 Room	106	12.00 x 8.90	5.30	115	60	70	118	30	27	36
A及B A and B	106	12.00 x 8.90	5.30	115	60	70	118	30	27	36
A或B A or B	53	8.90 x 6.00	5.30	58	30	30	50	18	21	24
达芬奇 DA VINCI 2801	54	9.43 x 5.80	3.59	57	32	30	52	19	21	24
卡萨诺瓦 CASA NOVA 2802	54	9.43 x 5.80	3.59	57	32	30	52	19	21	24
伽利略 GALILEO 2803	54	9.43 x 5.80	3.59	-	-	-	-	19	-	-
马可波罗 MARCO POLO 2804	54	9.43 x 5.80	3.59	-	-	-	-	19	-	-
迎宾区 Pre-function Area										
A	240	-	-	-	-	-	-	-	-	-
B	240	-	-	-	-	-	-	-	-	-
C	240	-	-	-	-	-	-	-	-	-
D	240	-	-	-	-	-	-	-	-	-
E	467	-	-	-	-	-	-	-	-	-
F	267	-	-	-	-	-	-	-	-	-
G	613	-	-	-	-	-	-	-	-	-
H	937	-	-	-	-	-	-	-	-	-

景观将视乎不同房间配置而定。所有的资讯在打印时已经确认正确无误。本公司有权对其进行更改。  
Room configuration may have obstructed views. All information is correct at the time of printing but may be subject to change without notice.



# 会议厅 - 澳门威尼斯人

## MEETING ROOMS - THE VENETIAN MACAO

### LG层 LOWER GROUND

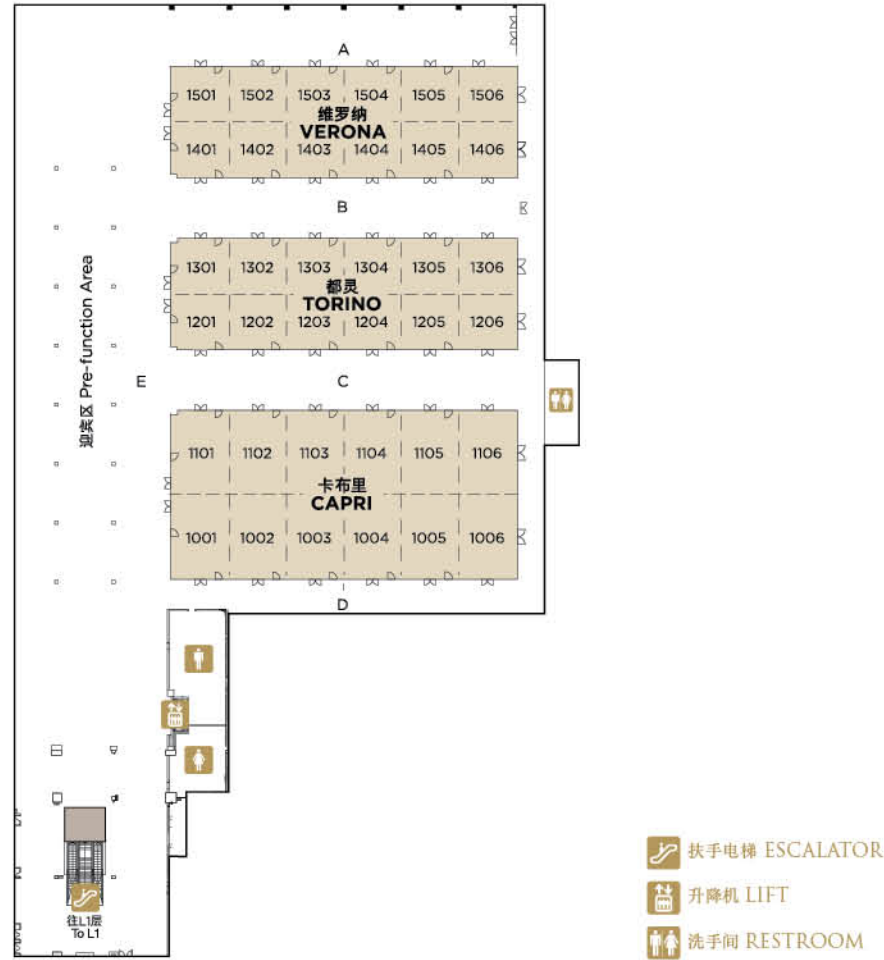

会议厅 Meeting Rooms	平方米 Area (sqm)	尺寸(米) Dimensions (M)	楼高(米) Height (M)	可容纳人数 Capacities						
				剧院模式 Theatre	课室模式 Classroom	宴会模式 Banquet	招待会模式 Reception	会议模式 Conference	U型模式 U-Shape	空心矩形模式 Hollow Square
<b>卡布里 CAPRI</b>										
12间会议厅 12 Rooms	1,420	54.20 x 26.20	3.00	1,400	720	1,250	1,500	-	-	-
10间会议厅 10 Rooms	1,168	44.60 x 26.20	3.00	1,208	558	940	1,350	-	-	-
8间会议厅 8 Rooms	935	35.70 x 26.20	3.00	888	450	780	1,000	-	-	-
6间会议厅 6 Rooms	701	26.80 x 26.20	3.00	632	318	560	750	-	-	-
4间会议厅 4 Rooms	468	17.90 x 26.20	3.00	376	210	390	580	-	-	-
3间会议厅 3 Rooms	348	26.80 x 13.00	3.00	270	171	280	400	-	65	85
2间会议厅 2 Rooms	232	17.90 x 13.00	3.00	210	110	180	250	-	60	80
1间会议厅 1 Room	117	13.00 x 9.00	3.00	120	66	70	130	35	30	35
<b>都灵 TORINO / 维罗纳 VERONA</b>										
12间会议厅 12 Rooms	932	54.20 x 17.20	3.00	880	425	770	932	-	-	-
10间会议厅 10 Rooms	767	44.60 x 17.20	3.00	680	345	600	765	-	-	-
8间会议厅 8 Rooms	614	35.70 x 17.20	3.00	560	306	480	640	-	-	-
6间会议厅 6 Rooms	460	26.80 x 17.20	3.00	360	168	370	570	-	-	-
4间会议厅 4 Rooms	307	17.90 x 17.20	3.00	240	135	240	360	-	-	-
3间会议厅 3 Rooms	228	26.80 x 8.53	3.00	200	90	180	250	-	60	80
2间会议厅 2 Rooms	152	17.90 x 8.53	3.00	150	75	120	180	-	40	50
1间会议厅 1 Room	76	9.00 x 8.50	3.00	60	40	60	100	24	24	30
<b>迎宾区 Pre-function Area</b>										
A	428	-	-	-	-	-	-	-	-	-
B	331	-	-	-	-	-	-	-	-	-
C	331	-	-	-	-	-	-	-	-	-
D	178	-	-	-	-	-	-	-	-	-
E	1,342	-	-	-	-	-	-	-	-	-

景观将视乎不同房间配置而定。所有的资讯在打印时已经确认正确无误，本公司有权对其进行更改。  
Room configuration may have obstructed views. All information is correct at the time of printing but may be subject to change without notice.

# IL PRATO户外活动草坪 - 澳门威尼斯人

## IL PRATO OUTDOOR EVENT LAWN - THE VENETIAN MACAO



IL PRATO是一个宽敞的户外活动草坪，毗邻澳门威尼斯人和澳门巴黎人，最多可容纳5,000人，适合举办鸡尾酒会和户外团体活动。  
Il Prato is a spacious outdoor event lawn adjacent to The Venetian Macao and The Parisian Macao, able to accommodate up to 5,000 delegates for cocktail-style events and creative outdoor team activities.

活动空间 Event Space	平方米 Area (sqm)	尺寸(米) Dimensions (M)
户外活动草坪 Il Prato	11,000	不规则 Irregular